



Instruction Manual

King

Flash E-TTL Trigger
For Canon



Overview

Thank you for purchasing PIXEL product

Thank you for purchasing the Pixel product --- King. King achieves high-sync flash shooting with Canon cameras and other creative lighting function including E-TTL II, E-TTL, FP...etc. King supports shutter speeds up to 1/8000 s. King has 3 different groups; each group can use multiple units and set each as individual power settings. When using the EOS EXII series flash, you can set the flash power in the camera menu, directly.

Please read this instruction manual completely and ensure proper operations with your flashgun before using this product.

Cautions

1. Make sure the camera and flash are powered off before installing the King.
2. As an electronic accessory this may be affected by rare environmental causes. Normal working operations should not be affected by this.

3. Drops or shocks will lead to product failure.
4. When not in use for long durations, please turned off the transmitter and the receiver's power and remove the battery.
5. The batteries should be installed correctly. Reverse polarity may cause batteries to leak corrosive liquids, heat or explosion.
6. When connecting the cable with the device, do not pull directly on the wires.
7. Do not store in a high temperature, such as an enclosed car under direct sunlight, the dashboard and other high-temperature areas.
8. Keep dry, do not contact wet hands with the product. Do not immerse in water or exposed to rain as this may lead to failure of the device.
9. Do not use near flammable gases. Failure to follow this warning may cause explosion or fire.
10. This product includes batteries; please strictly follow the instruction for proper operation. Failure to follow this may cause explosions, fire or personal injury.

Included items

Please check the listed items below in the package, please contact your dealer if there are missing items.

King Transmitter	1pc
King Receiver	1pc
PC-1/4 Connecting Cable (6.35mm)	1pc
PC-3.5 Connecting Cable	1pc
USB 2.0 Cable	1pc
Hot Shoe Protector	2pcs
Receiver Holder	1pc
Universal Flash Holder SF-18	1pc
Instruction Manual	1pc

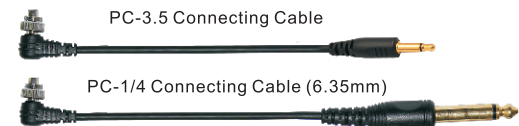

King Basic

Wireless System	
System Mode	Digital FSK 2.4GHz
Distance Range	Up to 100M
Wireless Channel	7
Performance	
Flash Mode	E-TTL, TTL, M
Sync Mode	1st Curtain, 2nd Curtain, High Speed Sync
Group Control	3 different groups (7 different combinations)
Function	King supports flash zooming, focal length, ISO, shutter speed, FV lock and FP
Sync Speed	1/8000S
Compatible Flash	Flashgun, Studio light and outdoor light
Focusing light	Transmitter support with focusing light
Trigger Mode	
Transmitter	Input support PC and Hot shoe.
Receiver	Output support TTL, Hot shoe and connecting cable socket.
Socket	
Transmitter	USB, PC, Cable input socket, Hot shoe input
Receiver	USB, PC, Cable output socket, Hot shoe output
Power	
Suitable Battery	TransmitterAA x 2pcs(support 1.2V rechargeable battery) or DC 5V power
	ReceiverAA x 2pcs(support 1.2V rechargeable battery)or DC 5V power
Standby	Transmitter 300Hrs(AA 1.2V 2400mAH rechargeable battery)
	Receiver 200Hrs(AA 1.2V 2400mAH rechargeable battery)

Function

Support flash power in camera menu
Support flash control in camera menu
Support EV
Support FE lock
Support camera group setting
Support 3 flashes output as different power
Support flash group setting on transmitter
Support 1st Curtain, 2nd Curtain and High speed sync
Support High speed sync for studio and outdoor light
Support well known brand flashes for High speed sync and TTL. (Metz, Sigma, Sunpak, Nissin)
Support well known brand flashes for trigger. (Does not support high speed sync and TTL flash)
Support firmware upgrade
Support multi receiver control
Support flash focusing light
When King is used with EOS EXII flash, flash power can be adjusted in camera menu.
Follow camera instructions for above usage.
Device does not support :
Do not support flashes using mixed modes, such as E-TTL and M together
No support for strobe mode
No support for Canon wireless flash system
No support for bracket exposure
No support for directly controlling flash mode and power for EX series flash as camera menu
Receiver does not support camera shutter and flash trigger at the same time.
Transmitter's hot shoe is NOT used for flashgun

Compatible Device

King transmitter compatible with
For the camera compatible list, please kindly to visit our website http://www.pixelhk.com
King receiver compatible with
➤ Canon EOS flash Canon EOS 580EXII, 580EX, 430EXII, 430EX, 320EX II, 270EXII, 220EXII Flash ➤ Aftermarket flash Metz, Sigma, Sunpak, Nissin ➤ Studio and outdoor flash
Support external flash control in camera menu
➤ 450D, 500D, 550D, 600D, 40D, 50D, 60D, 7D, 5D Mark II, 1D Mark III, 1D Mark IV, 1Ds Mark III ➤ This function can be controlled the flash directly from camera menu.
Support camera external flash control flashgun
➤ Canon 580EX II, 430EX II, 320EX, 270EX ; ➤ Metz AF-48, AF-50, AF-58

* All brand name(s), logo(s) are trademarks of third party company registered worldwide and were subject(s) as provided for information purposes only.

Using non compatible with menu setting camera model as below:

1. Canon 10D, 20D, 30D, 5D, 300D, 350D, 1D, 1D Mark II.
2. Above camera model do not have external flash function setting in camera menu; you can only set the channel and group on transmitter.

Name of each part

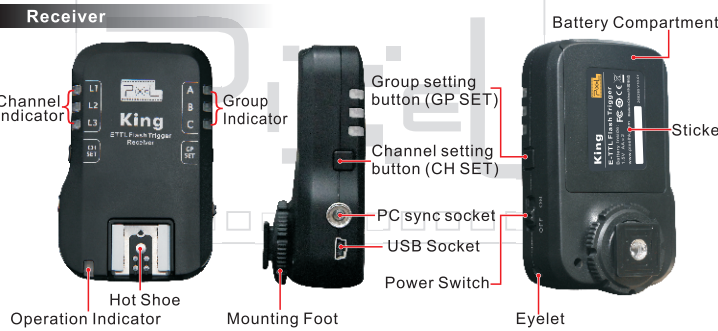
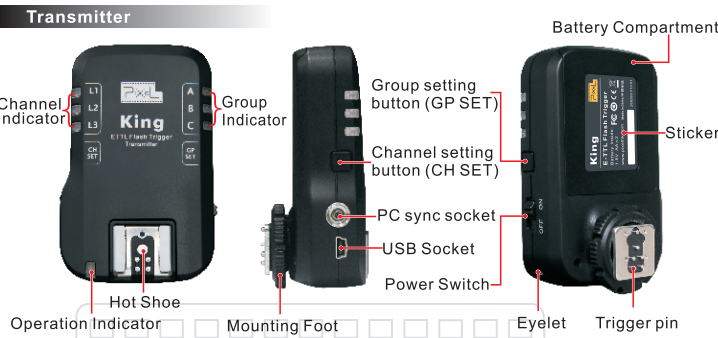

Name of each part

Eyelet: Use strap or lanyard to hold the device

Hot Shoe: Transmitter side---Only for use with N-ETTL (flash power controller). Receiver side---For attaching to the flashgun.

Channel setting button (CH SET): Set the device channel. Slightly press the button to check the current status; press again or hold for 2sec to enter setting mode.

Group setting button (GP SET): Set the device group. Slightly press the button to check the current status; press again or hold for 2sec to enter setting mode.

ChannelIndicator/GroupIndicator: These indicator lights show the group or channel working status.

Operation Indicator: Power, wireless communication or command indicator. Indicator displays as red when turning on the device; indicator displays as blue when the device communicate with camera.

Battery Compartment: Compartment for 2pcs AA battery, 1.2V to 1.6V

Receiver Lock Ring: Suitable to attach on tripod or screw nut.

PC Socket: PC output socket

Power Switch: Switch to OFF to turn off the device; switch to ON to turn on the device.

Transmitter Mounting Foot: Input interface connection with camera hot shoe.

UBS Socket: Used for firmware upgrade, DC 5V power supply, shutter rem

Sticker: Showing product S/N number, battery type on the sticker.

1. Power

Transmitter and receiver are using 2pcs AA battery which are compatible with 1.2V battery; also supports 5V DC power supplied through USB socket.	
King is using 2-steps power switch; switch to OFF to turn off and switch to ON to turn on.	
The setting will be saved after the power is off, even the different setting on each channel.	

2. Channel or Group:

- Slightly press CH SET and GP SET button to check the current status and enter setting mode.
- Setting: Press CH SET and GP SET to change the channel and group after entering setting mode; LED will turn off and exit from setting mode after 3sec.

3. Operation Indicator

- Operation indicator is a 2 color LED. Indicator will show red when the receiver is under standby mode; indicator will show blue when communicating with camera.



- Channel indicator has 3 red indicators which are L1, L2, and L3. Transmitter and receiver use the same setting method and can be set as 7 different channels. [L1], [L2], [L3], [L1, L3], [L2, L3], [L1, L2], [L1, L2, L3].

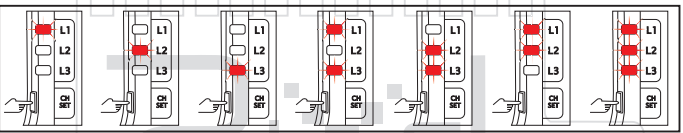

- Group indicator are 3 red indicators which are A, B and C. Transmitter and receiver use the same setting method and transmitter can be set as 7 different groups. [A], [B], [C], [A, C], [B, C], [A, B], [A, B, C].

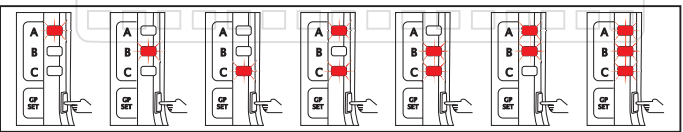

Receiver can be set as 3 different groups. [A], [B], [C].

