



Instruction Manual

King
Wireless TTL Flash Trigger
For Nikon



King Basic	
Wireless System	
System Mode	Digital FSK 2.4GHz
Distance Range	100M
Wireless Channel	7
Performance	
Flash Mode	I-TTL、TTL、M ,multi flash
Sync Mode	1st Curtain, 2nd Curtain, High Speed Sync, Red-eye reduction
Group Control	3 different groups (7 different combinations)
Function	King supports flash zooming, focal length, ISO, shutter speed, FV lock and FP
Sync Speed	1/8000S
Compatible Flash	Flashgun, Studio light and outdoor light
Focusing light	Transmitter support focusing light
Trigger Mode	
Transmitter	Output will support PC port and hot shoe trigger
Receiver	Output support TTL, Hot shoe and connecting cable socket.
Socket	
Transmitter	USB socket , PC port , Hot shoe output
Receiver	USB socket , PC port , Hot shoe output
Power	
Suitable Battery	TransmitterAA x 2pcs(support 1.2V rechargeable battery)or DC 5V power
	ReceiverAA x 2pcs(support 1.2V rechargeable battery)or DC 5V power
Standby	Trans mitter 200Hrs
	Receiver 100Hrs

Overview

Thank you for purchasing PIXEL product.

Thank you for purchasing Pixel product --- King. King achieves high-sync flash shooting with Nikon cameras and other creative lighting function including I-TTL, M, FP...etc. King supports shutter speeds up to 1/8000 s. King has 3 different groups; each group can use multiple units and set each as individual power settings.

Please read this instruction manual completely and ensure proper operations with your flashgun before using this product.

Cautions

1. Make sure the camera and flash are powered off before installing the King.
2. As an electronic accessory this may be affected by rare environmental causes. Normal working operations should not be affected by this.
3. Drops or shocks will lead to product failure.
4. When not in use for long durations, please turn off the transmitter's and the receiver's power and remove the battery.
5. The batteries should be installed correctly. Reverse polarity may cause batteries to leak corrosive liquids, heat or explosion.
6. When connecting the cable with the device, do not pull directly on the wires.
7. Do not store in a high temperature, such as an enclosed car under direct sunlight, the dashboard and other high-temperature areas.
8. Keep dry, do not touch the product with wet hands. Do not immerse in water or exposed to rain as this may lead to failure of the device.
9. Do not use near flammable gases. Failure to follow this warning may cause explosion or fire.
10. This product includes batteries; please strictly follow the instruction for proper operation. Failure to follow this may cause explosions, fire or personal injury.

Function

Support EV
Support flash group setting on transmitter
Support 1st Curtain, 2nd Curtain and High speed sync
Support High speed sync for studio and outdoor light
Support three flash groups with different flash ratio
Support well known brand flashes for High speed sync and TTL.
Support well known brand flashes for trigger. (May not support high speed sync and TTL flash or other function)
Support firmware upgrade
Support multi receiver control
Support flash focusing light

Follow camera instructions for above usage.

Included items

Please check the listed items below in the package, please contact your dealer if there are missing items.

King Transmitter	1pc
King Receiver	1pc
PC-1/4 Connecting Cable (6.35mm)	1pc
PC-3.5 Connecting Cable	1pc
USB 2.0 Cable	1pc
Receiver Holder	1pc
Universal Flash Holder SF-18	1pc
Instruction Manual	1pc

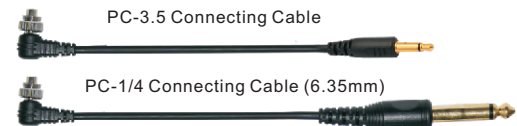

Name of each part

Transmitter

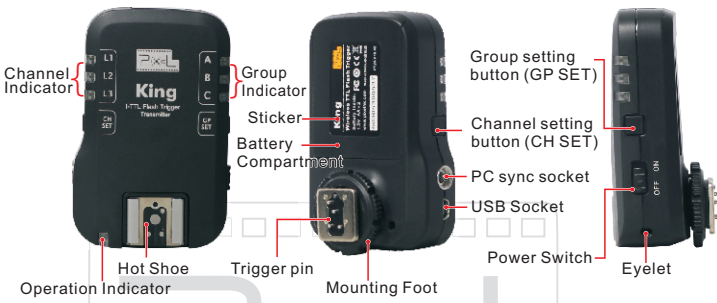

Receiver



Eyelet: Use strap or lanyard to hold the device

Hot Shoe: Hot shoe port for output, airborne flash is available for install

Channel setting button (CH SET): Set the channel of device . Slightly press the button to check the current status; press again or hold for 2sec to enter setting mode.

Group setting button (GP SET): Set the group of device. Slightly press the button to check the current status; press again or hold for 2sec to enter setting mode.

Channel Indicator/Group Indicator: These indicator lights show the group or channel working status.

Operation Indicator: Show the statue of power , transmission and output . blue light will flicking slowly under the stand-by mode ; blue light will flicking quickly under the Normal transmission ; red light will flicking quickly when under low power .

Battery Compartment: Compartment for 2pcs AA battery, 1.2V to 1.6V

Receiver Lock Ring: Suitable to attach on tripod or screw nut.

PC Socket: The receiver is the output. It can connect studio light and outdoor flash. The transmitter is the input.

Power Switch: Switch to OFF to turn off the device; switch to ON to turn on the device.

Transmitter Mounting Foot: Input interface connection with camera hot shoe.

UBS Socket: Used for firmware upgrade, DC 5V power supply.

Sticker: Showing product S/N number, battery type on the sticker.

1. Power

Transmitter and receiver are using 2pcs AA battery which are compatible with 1.2V battery; also supports 5V DC power supplied through USB socket.

King is using 2-steps power switch; switch to OFF to turn off and switch to ON to turn on.

The setting will be saved after the power is off, even the setting of each channel is different.

2. Channel or Group:

- Slightly press CH SET or GP SET button can check the current status of the device and enter into the setting mode. Press CH SET or GP SET button again can enter into next group or channel.
- Setting Method: After entering into the setting mode, slight press CH SET or GP SET button to switch the setting. Leaving it for 3 seconds to close LED and exit the setting mode. Or press another SET button to close LED, exit and save the setting.

3. Operation Indicator

- Show the statue of power, transmission and output. blue light will flicking slowly under the stand-by mode; blue light will flicking quickly under the Normal transmission; red light will flicking quickly when under low power.
- Channel indicator has 3 red indicators which are L1, L2, and L3. Transmitter and receiver use the same setting method and can be set as 7 different channels. [L1], [L2], [L3], [L1, L2], [L2, L3], [L1, L3], [L1, L2, L3].

7

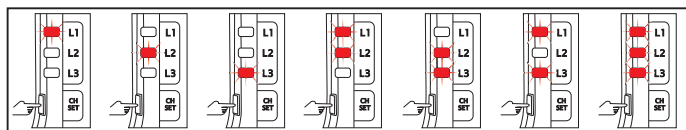

- Group indicator are 3 red indicators which are A, B and C. Transmitter and receiver use the same setting method and transmitter can be set as 7 different groups. [A], [B], [C], [A, B], [B, C], [A, C], [A, B, C].

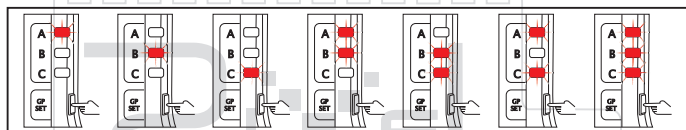

Receiver can be set as 3 different groups. [A], [B], [C].



Device Installation

Transmitter Installation

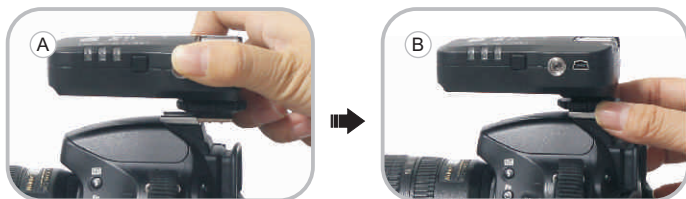

- Loosen the transmitter lock ring to the right and insert into camera hot shoe; tighten the transmitter lock ring to the left.

8

Receiver Installation

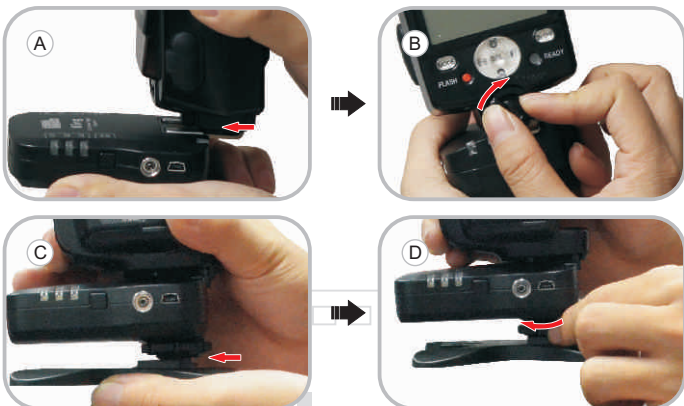

- Insert flashgun to receiver's hot shoe.
- Follow the flashgun locking system to lock the flash.
- Insert this receiver on the multi use flash holder and tight the transmitter lock ring to the left.

Operation Instruction

The following picture shows how to operate the compatible camera and speedlite. (The example devices are Nikon D700 camera and SB-910 speedlite)

Camera Mode

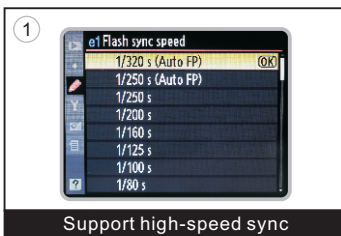

Support high-speed sync

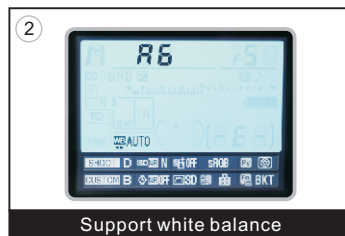

Support white balance

9



Support exposure compensation



Support ISO sensitivity

Flash Mode

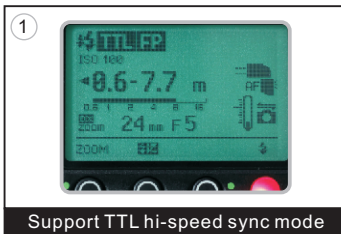

Support TTL hi-speed sync mode

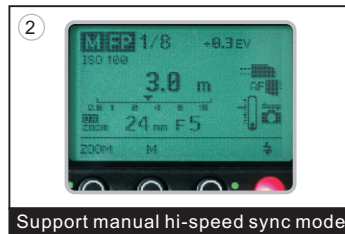

Support manual hi-speed sync mode

Picture shows the lead flashing operation from the machine

- The transmitter is mounted on the hot shoe of the top of the camera, trigger off-camera flash sync



Off-lead flashing studio lights



Off-lead flashing airborne lights

10

- The transmitter supports the installation of the airborne light without affecting the TTL communication of the airborne light and the camera and can send out the flashing signals simultaneously, trigger off-camera studio lights or airborne lights with TTL sync.



Airborne light TTL+Studio light lead lights from the machine



Airborne light TTL+Airborne off-camera TTL light or flash

Group Flashing

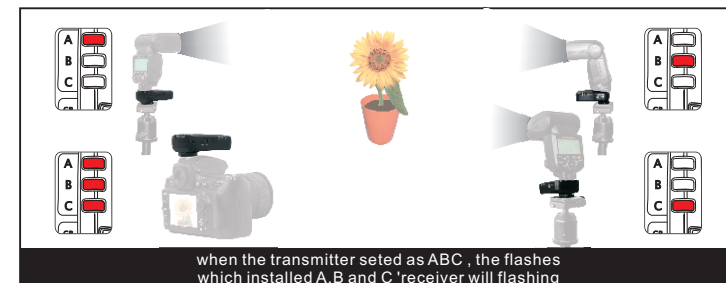

when the transmitter seted as ABC, the flashes which installed A,B and C' receiver will flashing

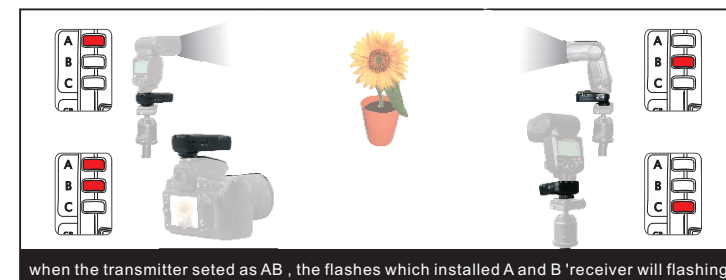

when the transmitter seted as AB, the flashes which installed A and B' receiver will flashing

11

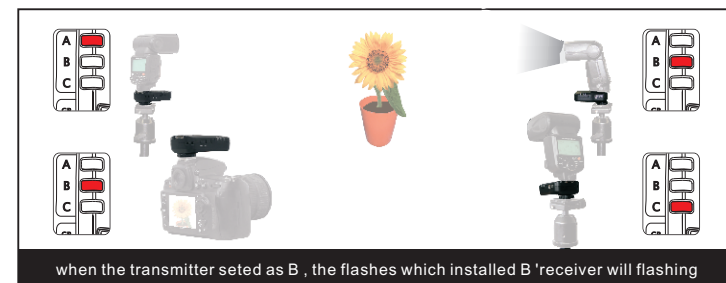

when the transmitter seted as B, the flashes which installed B' receiver will flashing

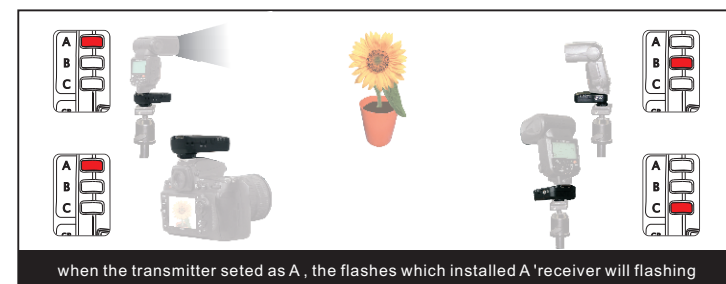

when the transmitter seted as A, the flashes which installed A' receiver will flashing

Thank you for purchasing PIXEL product and read this instruction manual carefully. If you have any question please kindly contact our local dealer or visit <http://www.pixelhk.com>.

The information in this manual is updated to 1st January, 2012. If you want to use together with other product released after this date, please consult Pixel's dealer for related information.

Firmware upgrade link: <http://pixelhk.com/down/kingnikon>



PSM36 V10.01